

This document, together with the concepts and designs presented herein, is intended only for the specific purpose and client for which it was prepared. Reuse of and improper reliance on this document without written authorization and adaptation by Kinney-Horn and Associates, Inc. shall be without liability to Kinney-Horn and Associates, Inc.

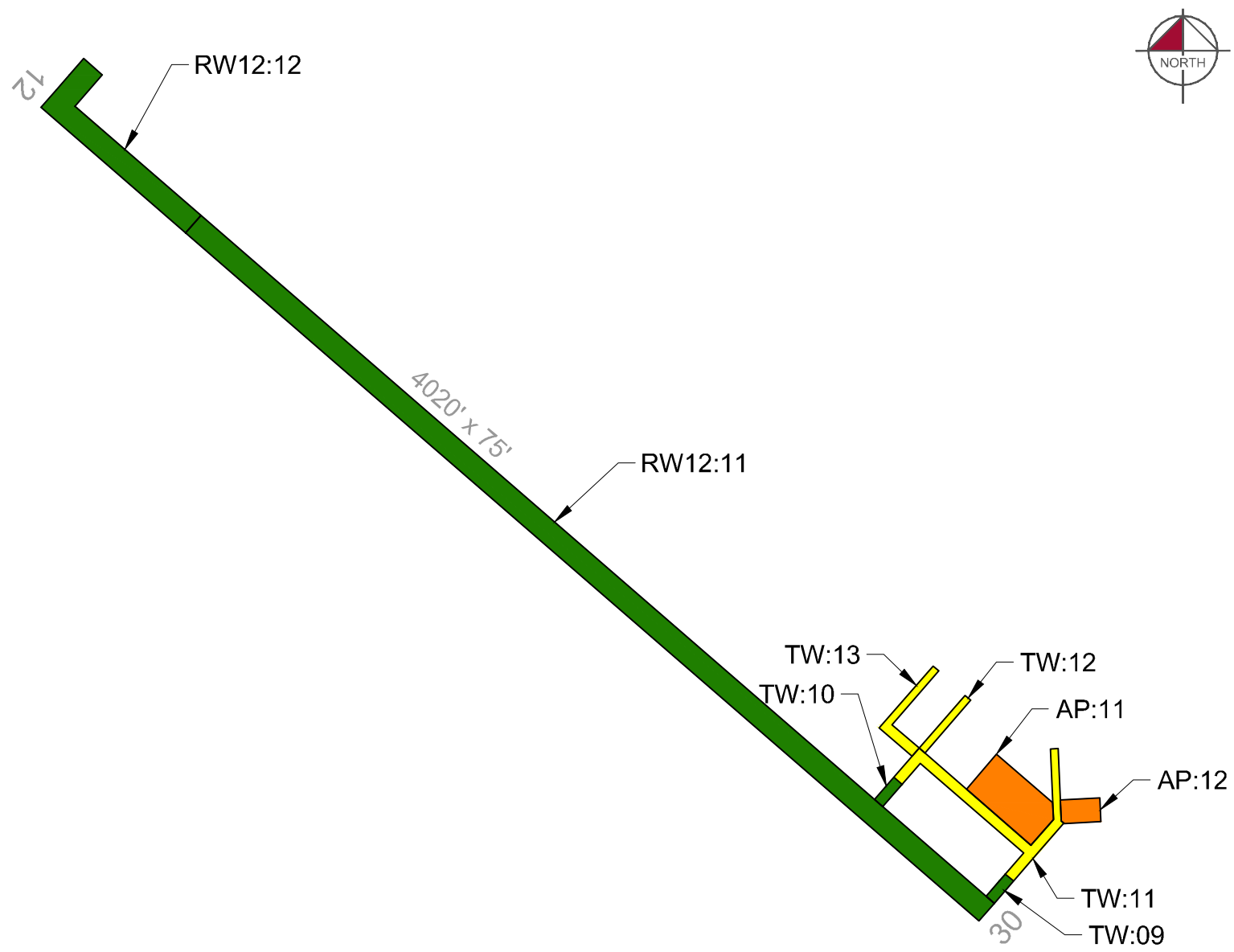

**LEGEND**

—	BRANCH IDENTIFIER
—	SECTION IDENTIFIER
—	SECTION BOUNDARY
■ (Green)	PCI 86-100 GOOD
■ (Yellow)	PCI 71-85 SATISFACTORY
■ (Light Yellow)	PCI 56-70 FAIR
■ (Orange)	PCI 41-55 POOR
■ (Pink)	PCI 26-40 VERY POOR
■ (Red)	PCI 11-25 SERIOUS
■ (Grey)	PCI 0-10 FAILED

**CURRENT 2021 PAVEMENT CONDITION INDEX**

Branch ID	Section ID	Branch Name	Surface Type	Section Area (SF)	Approx. Age at Inspection	Last Major Work Date	Last Inspection Date	Pavement Condition Index	PCI Category
AP	11	Apron	AC	46,500	23.3	8/1/1998	8/28/2021	51	Poor
AP	12	Apron	AC	9,728	23.3	8/1/1998	8/28/2021	54	Poor
RW12	11	Runway 12-30	AAC	255,000	2.8	1/1/2019	8/28/2021	90	Good
RW12	12	Runway 12-30	AAC	46,500	2.8	1/1/2019	8/28/2021	91	Good
TW	09	Taxiway	AAC	3,325	2.8	1/1/2019	8/28/2021	89	Good
TW	10	Taxiway	AAC	3,325	2.8	1/1/2019	8/28/2021	90	Good
TW	11	Taxiway	AC	24,281	23.3	8/1/1998	8/28/2021	66	Fair
TW	12	Taxiway	AC	5,750	23.3	8/1/1998	8/28/2021	66	Fair
TW	13	Taxiway	AC	12,577	18.3	8/1/2003	8/28/2021	61	Fair

**AIRFIELD PAVEMENT WORK HISTORY**

- ADAP-01, 1979, CONSTRUCT RUNWAY EXTENSION, CONNECTING TAXIWAY, AND APRON EXTENSIONS; RESURFACE RUNWAY, TAXIWAY, AND APRON.
- AIP-001-1985, REHABILITATE ALL PAVEMENTS.
- AIP-002-1998, RECONSTRUCT RUNWAY, TAXIWAYS, AND APRON; CONSTRUCT HANGAR ACCESS TAXIWAY (T-12).
- AIP-003-2003, CONSTRUCT HANGAR ACCESS TAXIWAY (T-13); CRACK SEAL, FOG SEAL, AND REMARK ALL PAVEMENTS.
- AIP-006-2010, CRACK SEAL, FOG SEAL, AND REMARK ALL PAVEMENTS.
- AIP-008-2014, CRACK SEAL, SEAL COAT, AND REMARK ALL PAVEMENTS. [MAINTENANCE DONE IN 2015, INSPECTED AFTER PROJECT]
- 2019 RUNWAY 12-30, TW:09 AND TW:10 2" MILL AND OVERLAY. P-401 ASPHALT.

Runway



*RW12-11-31: L&T Cracking*



*RW12-12-11: Weathering*



Taxiway



*TW11-04: Alligator Cracking*



*TW13-02: L&T Cracking*



Apron



*AP11-01: L&T Cracking*



*AP12-02: Overview*



## Re-Inspection Report

MDT SASP 2021

Generated Date 12/3/2021

Page 1 of 9

**Network:** 9S2 **Name:** Scobey Airport

**Branch:** AP **Name:** Apron **Use:** APRON **Area:** 56,228 SqFt

**Section:** 11 of 2 **From:** MAIN APRON **To:** **Last Const.:** 8/1/1998

**Surface:** AC **Family:** DEFAULT **Zone:** SCOB **Category:** D **Rank:** P

**Area:** 46,500 SqFt **Length:** 310 Ft **Width:** 150 Ft

**Slabs:** **Slab Length:** Ft **Slab Width:** Ft **Joint Length:** Ft

**Shoulder:** **Street Type:** ACN **Grade:** 0 **Lanes:** 0

**Section Comments:**

**Work Date:** 8/1/1998 **Work Type:** New Construction - Initial **Code:** NU-IN **Is Major M&R:** True

**Last Insp. Date:** 8/28/2021 **Total Samples:** 9 **Surveyed:** 4

**Conditions:** PCI: 51

**Inspection Comments:**

**Sample Number:** 01 **Type:** R **Area:** 5100.00 SqFt **PCI:** 50

**Sample Comments:**

48	L & T CR	L	273.00 Ft
48	L & T CR	M	473.00 Ft
57	WEATHERING	L	4080.00 SqFt
57	WEATHERING	M	1020.00 SqFt

**Sample Number:** 04 **Type:** R **Area:** 5100.00 SqFt **PCI:** 58

**Sample Comments:**

41	ALLIGATOR CR	L	6.00 SqFt
48	L & T CR	L	451.00 Ft
48	L & T CR	M	175.00 Ft
57	WEATHERING	L	4080.00 SqFt
57	WEATHERING	M	1020.00 SqFt

**Sample Number:** 06 **Type:** R **Area:** 5100.00 SqFt **PCI:** 46

**Sample Comments:**

48	L & T CR	L	160.00 Ft
48	L & T CR	M	624.00 Ft
57	WEATHERING	L	4080.00 SqFt
57	WEATHERING	M	1020.00 SqFt

**Sample Number:** 07 **Type:** R **Area:** 5100.00 SqFt **PCI:** 51

**Sample Comments:**

48	L & T CR	L	488.00 Ft
48	L & T CR	M	437.00 Ft
57	WEATHERING	L	4080.00 SqFt
57	WEATHERING	M	1020.00 SqFt



---

**Network:** 9S2 **Name:** Scobey Airport

---

**Branch:** AP **Name:** Apron **Use:** APRON **Area:** 56,228 SqFt

---

**Section:** 12 of 2 **From:** EAST APRON **To:** **Last Const.:** 8/1/1998

**Surface:** AC **Family:** DEFAULT **Zone:** SCOB **Category:** D **Rank:** P

**Area:** 9,728 SqFt **Length:** 128 Ft **Width:** 76 Ft

**Slabs:** **Slab Length:** Ft **Slab Width:** Ft **Joint Length:** Ft

**Shoulder:** **Street Type:** ACN **Grade:** 0 **Lanes:** 0

**Section Comments:**

---

**Work Date:** 8/1/1998 **Work Type:** New Construction - Initial **Code:** NU-IN **Is Major M&R:** True

---

**Last Insp. Date:** 8/28/2021 **TotalSamples:** 2 **Surveyed:** 2

**Conditions:** PCI: 54

**Inspection Comments:**

---

**Sample Number:** 01 **Type:** R **Area:** 4480.00 SqFt **PCI:** 51

**Sample Comments:**

41 ALLIGATOR CR L 24.00 SqFt

48 L & T CR L 227.00 Ft

48 L & T CR M 285.00 Ft

57 WEATHERING L 3136.00 SqFt

57 WEATHERING M 1344.00 SqFt

---

**Sample Number:** 02 **Type:** R **Area:** 4480.00 SqFt **PCI:** 56

**Sample Comments:**

45 DEPRESSION L 36.00 SqFt

48 L & T CR L 145.00 Ft

48 L & T CR M 174.00 Ft

52 RAVELING L 9.00 SqFt

57 WEATHERING L 3130.00 SqFt

57 WEATHERING M 1341.00 SqFt



<b>Network:</b>	9S2	<b>Name:</b>	Scobey Airport						
<b>Branch:</b>	RW12	<b>Name:</b>	Runway 12-30	<b>Use:</b>	RUNWAY	<b>Area:</b>	301,500 SqFt		
<b>Section:</b>	11	of 2	<b>From:</b>	STA 26+00	<b>To:</b>	STA 60+00	<b>Last Const.:</b>	1/1/2019	
<b>Surface:</b>	AAC	<b>Family:</b>	DEFAULT	<b>Zone:</b>	SCOB	<b>Category:</b>	D	<b>Rank:</b>	P
<b>Area:</b>	255,000 SqFt	<b>Length:</b>	3,400 Ft	<b>Width:</b>	75 Ft				
<b>Slabs:</b>		<b>Slab Length:</b>	Ft	<b>Slab Width:</b>	Ft	<b>Joint Length:</b>	Ft		
<b>Shoulder:</b>		<b>Street Type:</b>	ACR	<b>Grade:</b>	0	<b>Lanes:</b>	0		
<b>Section Comments:</b>									
<b>Work Date:</b>	8/1/1998	<b>Work Type:</b>	New Construction - Initial		<b>Code:</b>	NU-IN	<b>Is Major M&amp;R:</b>	True	
<b>Work Date:</b>	1/1/2019	<b>Work Type:</b>	Overlay-AC		<b>Code:</b>	OL-AC	<b>Is Major M&amp;R:</b>	True	
<b>Last Insp. Date:</b>	8/28/2021	<b>TotalSamples:</b>	52	<b>Surveyed:</b>	6				
<b>Conditions:</b>	PCI: 90								
<b>Inspection Comments:</b>									
<b>Sample Number:</b>	05	<b>Type:</b>	R	<b>Area:</b>	4875.00 SqFt	<b>PCI:</b>	91		
<b>Sample Comments:</b>									
48	L & T CR	L	27.00	Ft					
57	WEATHERING	L	2438.00	SqFt					
<b>Sample Number:</b>	15	<b>Type:</b>	R	<b>Area:</b>	4875.00 SqFt	<b>PCI:</b>	89		
<b>Sample Comments:</b>									
48	L & T CR	L	82.00	Ft					
57	WEATHERING	L	2438.00	SqFt					
<b>Sample Number:</b>	20	<b>Type:</b>	R	<b>Area:</b>	4875.00 SqFt	<b>PCI:</b>	91		
<b>Sample Comments:</b>									
48	L & T CR	L	21.00	Ft					
57	WEATHERING	L	2438.00	SqFt					
<b>Sample Number:</b>	31	<b>Type:</b>	R	<b>Area:</b>	4875.00 SqFt	<b>PCI:</b>	89		
<b>Sample Comments:</b>									
48	L & T CR	L	76.00	Ft					
57	WEATHERING	L	2438.00	SqFt					
<b>Sample Number:</b>	40	<b>Type:</b>	R	<b>Area:</b>	4875.00 SqFt	<b>PCI:</b>	89		
<b>Sample Comments:</b>									
48	L & T CR	L	84.00	Ft					
57	WEATHERING	L	2438.00	SqFt					
<b>Sample Number:</b>	51	<b>Type:</b>	R	<b>Area:</b>	4875.00 SqFt	<b>PCI:</b>	93		
<b>Sample Comments:</b>									
48	L & T CR	L	5.00	Ft					
57	WEATHERING	L	2438.00	SqFt					



<b>Network:</b>	9S2	<b>Name:</b>	Scobey Airport						
<b>Branch:</b>	RW12	<b>Name:</b>	Runway 12-30	<b>Use:</b>	RUNWAY	<b>Area:</b>	301,500 SqFt		
<b>Section:</b>	12	of 2	<b>From:</b>	STA 19+80	<b>To:</b>	STA 26+00	<b>Last Const.:</b>	1/1/2019	
<b>Surface:</b>	AAC	<b>Family:</b>	DEFAULT	<b>Zone:</b>	SCOB	<b>Category:</b>	D	<b>Rank:</b>	P
<b>Area:</b>	46,500 SqFt	<b>Length:</b>	620 Ft	<b>Width:</b>	75 Ft				
<b>Slabs:</b>	<b>Slab Length:</b>	Ft	<b>Slab Width:</b>	Ft	<b>Joint Length:</b>	Ft			
<b>Shoulder:</b>	<b>Street Type:</b>	ACR	<b>Grade:</b>	0	<b>Lanes:</b>	0			
<b>Section Comments:</b>									
<b>Work Date:</b>	8/1/1998	<b>Work Type:</b>	New Construction - Initial		<b>Code:</b>	NU-IN	<b>Is Major M&amp;R:</b>	True	
<b>Work Date:</b>	1/1/2019	<b>Work Type:</b>	Overlay-AC		<b>Code:</b>	OL-AC	<b>Is Major M&amp;R:</b>	True	
<b>Last Insp. Date:</b>	8/28/2021	<b>TotalSamples:</b>	11	<b>Surveyed:</b>	5				
<b>Conditions:</b>	PCI:	91							
<b>Inspection Comments:</b>									
<b>Sample Number:</b>	01	<b>Type:</b>	R	<b>Area:</b>	4875.00 SqFt	<b>PCI:</b>	90		
<b>Sample Comments:</b>									
48	L & T CR	L	44.00	Ft					
57	WEATHERING	L	2438.00	SqFt					
<b>Sample Number:</b>	05	<b>Type:</b>	R	<b>Area:</b>	4875.00 SqFt	<b>PCI:</b>	88		
<b>Sample Comments:</b>									
48	L & T CR	L	88.00	Ft					
57	WEATHERING	L	2438.00	SqFt					
<b>Sample Number:</b>	08	<b>Type:</b>	R	<b>Area:</b>	4875.00 SqFt	<b>PCI:</b>	92		
<b>Sample Comments:</b>									
48	L & T CR	L	12.00	Ft					
57	WEATHERING	L	2438.00	SqFt					
<b>Sample Number:</b>	10	<b>Type:</b>	R	<b>Area:</b>	4875.00 SqFt	<b>PCI:</b>	95		
<b>Sample Comments:</b>									
57	WEATHERING	L	2438.00	SqFt					
<b>Sample Number:</b>	11	<b>Type:</b>	R	<b>Area:</b>	5440.00 SqFt	<b>PCI:</b>	91		
<b>Sample Comments:</b>									
48	L & T CR	L	28.00	Ft					
57	WEATHERING	L	2720.00	SqFt					

<b>Network:</b>	9S2	<b>Name:</b>	Scobey Airport						
<b>Branch:</b>	TW	<b>Name:</b>	Taxiway	<b>Use:</b>	TAXIWAY	<b>Area:</b>	49,258 SqFt		
<b>Section:</b>	09	of 5	<b>From:</b>	R-11	<b>To:</b>	T-12, A-11, & A-12	<b>Last Const.:</b>	1/1/2019	
<b>Surface:</b>	AAC	<b>Family:</b>	DEFAULT	<b>Zone:</b>	SCOB	<b>Category:</b>	D	<b>Rank:</b>	P
<b>Area:</b>	3,325 SqFt	<b>Length:</b>	95 Ft	<b>Width:</b>	35 Ft				
<b>Slabs:</b>	<b>Slab Length:</b>	Ft	<b>Slab Width:</b>	Ft	<b>Joint Length:</b>	Ft			
<b>Shoulder:</b>	<b>Street Type:</b>	ACR	<b>Grade:</b>	0	<b>Lanes:</b>	0			
<b>Section Comments:</b>									
<b>Work Date:</b>	8/1/1998	<b>Work Type:</b>	New Construction - Initial		<b>Code:</b>	NU-IN	<b>Is Major M&amp;R:</b>	True	
<b>Work Date:</b>	1/1/2019	<b>Work Type:</b>	Overlay-AC		<b>Code:</b>	OL-AC	<b>Is Major M&amp;R:</b>	True	
<b>Last Insp. Date:</b>	8/28/2021	<b>TotalSamples:</b>	1	<b>Surveyed:</b>	1				
<b>Conditions:</b>	PCI:	89							
<b>Inspection Comments:</b>									
<b>Sample Number:</b>	01	<b>Type:</b>	R	<b>Area:</b>	3325.00 SqFt	<b>PCI:</b>	89		
<b>Sample Comments:</b>									
48	L & T CR	L	57.00	Ft					
57	WEATHERING	L	1662.00	SqFt					



<b>Network:</b>	9S2	<b>Name:</b>	Scobey Airport						
<b>Branch:</b>	TW	<b>Name:</b>	Taxiway	<b>Use:</b>	TAXIWAY	<b>Area:</b>	49,258 SqFt		
<b>Section:</b>	10	of 5	<b>From:</b>	R-11	<b>To:</b>	T-12, A-11, & A-12	<b>Last Const.:</b>	1/1/2019	
<b>Surface:</b>	AAC	<b>Family:</b>	DEFAULT	<b>Zone:</b>	SCOB	<b>Category:</b>	D	<b>Rank:</b>	P
<b>Area:</b>	3,325 SqFt	<b>Length:</b>	95 Ft	<b>Width:</b>	35 Ft				
<b>Slabs:</b>	<b>Slab Length:</b>	Ft	<b>Slab Width:</b>	Ft	<b>Joint Length:</b>	Ft			
<b>Shoulder:</b>	<b>Street Type:</b>	ACR	<b>Grade:</b>	0	<b>Lanes:</b>	0			
<b>Section Comments:</b>									
<b>Work Date:</b>	8/1/1998	<b>Work Type:</b>	New Construction - Initial		<b>Code:</b>	NU-IN	<b>Is Major M&amp;R:</b>	True	
<b>Work Date:</b>	1/1/2019	<b>Work Type:</b>	Overlay-AC		<b>Code:</b>	OL-AC	<b>Is Major M&amp;R:</b>	True	
<b>Last Insp. Date:</b>	8/28/2021	<b>TotalSamples:</b>	1	<b>Surveyed:</b>	1				
<b>Conditions:</b>	PCI:	90							
<b>Inspection Comments:</b>									
<b>Sample Number:</b>	01	<b>Type:</b>	R	<b>Area:</b>	3325.00 SqFt	<b>PCI:</b>	90		
<b>Sample Comments:</b>									
48	L & T CR	L	35.00	Ft					
57	WEATHERING	L	1662.00	SqFt					

<b>Network:</b>	9S2	<b>Name:</b>	Scobey Airport						
<b>Branch:</b>	TW	<b>Name:</b>	Taxiway	<b>Use:</b>	TAXIWAY	<b>Area:</b>	49,258 SqFt		
<b>Section:</b>	11	of 5	<b>From:</b>	R-11	<b>To:</b>	T-12, A-11, & A-12	<b>Last Const.:</b>	8/1/1998	
<b>Surface:</b>	AC	<b>Family:</b>	DEFAULT	<b>Zone:</b>	SCOB	<b>Category:</b>	D	<b>Rank:</b>	P
<b>Area:</b>	24,281 SqFt	<b>Length:</b>	512 Ft	<b>Width:</b>	125 Ft				
<b>Slabs:</b>	<b>Slab Length:</b>	Ft	<b>Slab Width:</b>	Ft	<b>Joint Length:</b>	Ft			
<b>Shoulder:</b>	<b>Street Type:</b>	ACR	<b>Grade:</b>	0	<b>Lanes:</b>	0			
<b>Section Comments:</b>									
<b>Work Date:</b>	8/1/1998	<b>Work Type:</b>	New Construction - Initial		<b>Code:</b>	NU-IN	<b>Is Major M&amp;R:</b>	True	
<b>Last Insp. Date:</b>	8/28/2021	<b>TotalSamples:</b>	6	<b>Surveyed:</b>	6				
<b>Conditions:</b>	PCI: 66								
<b>Inspection Comments:</b>									
<b>Sample Number:</b>	01	<b>Type:</b>	R	<b>Area:</b>	5000.00 SqFt	<b>PCI:</b>	91		
<b>Sample Comments:</b>									
48	L & T CR	L	35.00	Ft					
57	WEATHERING	L	2500.00	SqFt					
<b>Sample Number:</b>	02	<b>Type:</b>	R	<b>Area:</b>	5145.00 SqFt	<b>PCI:</b>	50		
<b>Sample Comments:</b>									
48	L & T CR	L	294.00	Ft					
48	L & T CR	M	335.00	Ft					
48	L & T CR	H	20.00	Ft					
57	WEATHERING	L	4373.00	SqFt					
57	WEATHERING	M	772.00	SqFt					
<b>Sample Number:</b>	03	<b>Type:</b>	R	<b>Area:</b>	5180.00 SqFt	<b>PCI:</b>	58		
<b>Sample Comments:</b>									
48	L & T CR	L	240.00	Ft					
48	L & T CR	M	192.00	Ft					
48	L & T CR	H	17.00	Ft					
57	WEATHERING	L	4403.00	SqFt					
57	WEATHERING	M	777.00	SqFt					
<b>Sample Number:</b>	04	<b>Type:</b>	R	<b>Area:</b>	5145.00 SqFt	<b>PCI:</b>	59		
<b>Sample Comments:</b>									
48	L & T CR	L	160.00	Ft					
48	L & T CR	M	265.00	Ft					
57	WEATHERING	L	4373.00	SqFt					
57	WEATHERING	M	772.00	SqFt					
<b>Sample Number:</b>	06	<b>Type:</b>	R	<b>Area:</b>	5145.00 SqFt	<b>PCI:</b>	90		
<b>Sample Comments:</b>									
48	L & T CR	L	57.00	Ft					
57	WEATHERING	L	2572.00	SqFt					
<b>Sample Number:</b>	07	<b>Type:</b>	R	<b>Area:</b>	5000.00 SqFt	<b>PCI:</b>	49		
<b>Sample Comments:</b>									
41	ALLIGATOR CR	L	51.00	SqFt					
48	L & T CR	L	87.00	Ft					
48	L & T CR	M	280.00	Ft					
48	L & T CR	H	25.00	Ft					
57	WEATHERING	L	4000.00	SqFt					
57	WEATHERING	M	1000.00	SqFt					



<b>Network:</b>	9S2	<b>Name:</b>	Scobey Airport						
<b>Branch:</b>	TW	<b>Name:</b>	Taxiway	<b>Use:</b>	TAXIWAY	<b>Area:</b>	49,258 SqFt		
<b>Section:</b>	12	of 5	<b>From:</b>	T-1	<b>To:</b>	HANGARS	<b>Last Const.:</b>	8/1/1998	
<b>Surface:</b>	AC	<b>Family:</b>	DEFAULT	<b>Zone:</b>	SCOB	<b>Category:</b>	D	<b>Rank:</b>	P
<b>Area:</b>	5,750 SqFt	<b>Length:</b>	230 Ft	<b>Width:</b>	25 Ft				
<b>Slabs:</b>	<b>Slab Length:</b>	Ft	<b>Slab Width:</b>	Ft	<b>Joint Length:</b>	Ft			
<b>Shoulder:</b>	<b>Street Type:</b>	ACR	<b>Grade:</b>	0	<b>Lanes:</b>	0			
<b>Section Comments:</b>									
<b>Work Date:</b>	8/1/1998	<b>Work Type:</b>	New Construction - Initial		<b>Code:</b>	NU-IN	<b>Is Major M&amp;R:</b>	True	
<b>Last Insp. Date:</b>	8/28/2021	<b>TotalSamples:</b>	1	<b>Surveyed:</b>	1				
<b>Conditions:</b>	PCI: 66								
<b>Inspection Comments:</b>									
<b>Sample Number:</b>	01	<b>Type:</b>	R	<b>Area:</b>	5625.00 SqFt	<b>PCI:</b>	66		
<b>Sample Comments:</b>									
48	L & T CR	L	413.00	Ft					
48	L & T CR	H	15.00	Ft					
57	WEATHERING	L	4500.00	SqFt					
57	WEATHERING	M	1125.00	SqFt					

<b>Network:</b>	9S2	<b>Name:</b>	Scobey Airport						
<b>Branch:</b>	TW	<b>Name:</b>	Taxiway	<b>Use:</b>	TAXIWAY	<b>Area:</b>	49,258 SqFt		
<b>Section:</b>	13	of 5	<b>From:</b>	T-11	<b>To:</b>	HANGARS	<b>Last Const.:</b>	8/1/2003	
<b>Surface:</b>	AC	<b>Family:</b>	DEFAULT	<b>Zone:</b>	SCOB	<b>Category:</b>	D	<b>Rank:</b>	P
<b>Area:</b>	12,577 SqFt	<b>Length:</b>	374 Ft	<b>Width:</b>	25 Ft				
<b>Slabs:</b>		<b>Slab Length:</b>	Ft	<b>Slab Width:</b>	Ft	<b>Joint Length:</b>	Ft		
<b>Shoulder:</b>		<b>Street Type:</b>	ACR	<b>Grade:</b>	0	<b>Lanes:</b>	0		
<b>Section Comments:</b>									
<b>Work Date:</b>	8/1/2003	<b>Work Type:</b>	New Construction - Initial		<b>Code:</b>	NU-IN	<b>Is Major M&amp;R:</b>	True	
<b>Last Insp. Date:</b>	8/28/2021	<b>TotalSamples:</b>	2	<b>Surveyed:</b>	2				
<b>Conditions:</b>	PCI: 61								
<b>Inspection Comments:</b>									
<b>Sample Number:</b>	01	<b>Type:</b>	R	<b>Area:</b>	4025.00 SqFt	<b>PCI:</b>	55		
<b>Sample Comments:</b>									
48	L & T CR	L	271.00	Ft					
48	L & T CR	M	200.00	Ft					
52	RAVELING	L	105.00	SqFt					
57	WEATHERING	L	3136.00	SqFt					
57	WEATHERING	M	784.00	SqFt					
<b>Sample Number:</b>	02	<b>Type:</b>	R	<b>Area:</b>	6700.00 SqFt	<b>PCI:</b>	65		
<b>Sample Comments:</b>									
48	L & T CR	L	58.00	Ft					
48	L & T CR	M	170.00	Ft					
48	L & T CR	H	15.00	Ft					
57	WEATHERING	L	5360.00	SqFt					
57	WEATHERING	M	1340.00	SqFt					