

SCOBEY

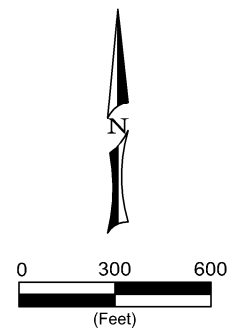
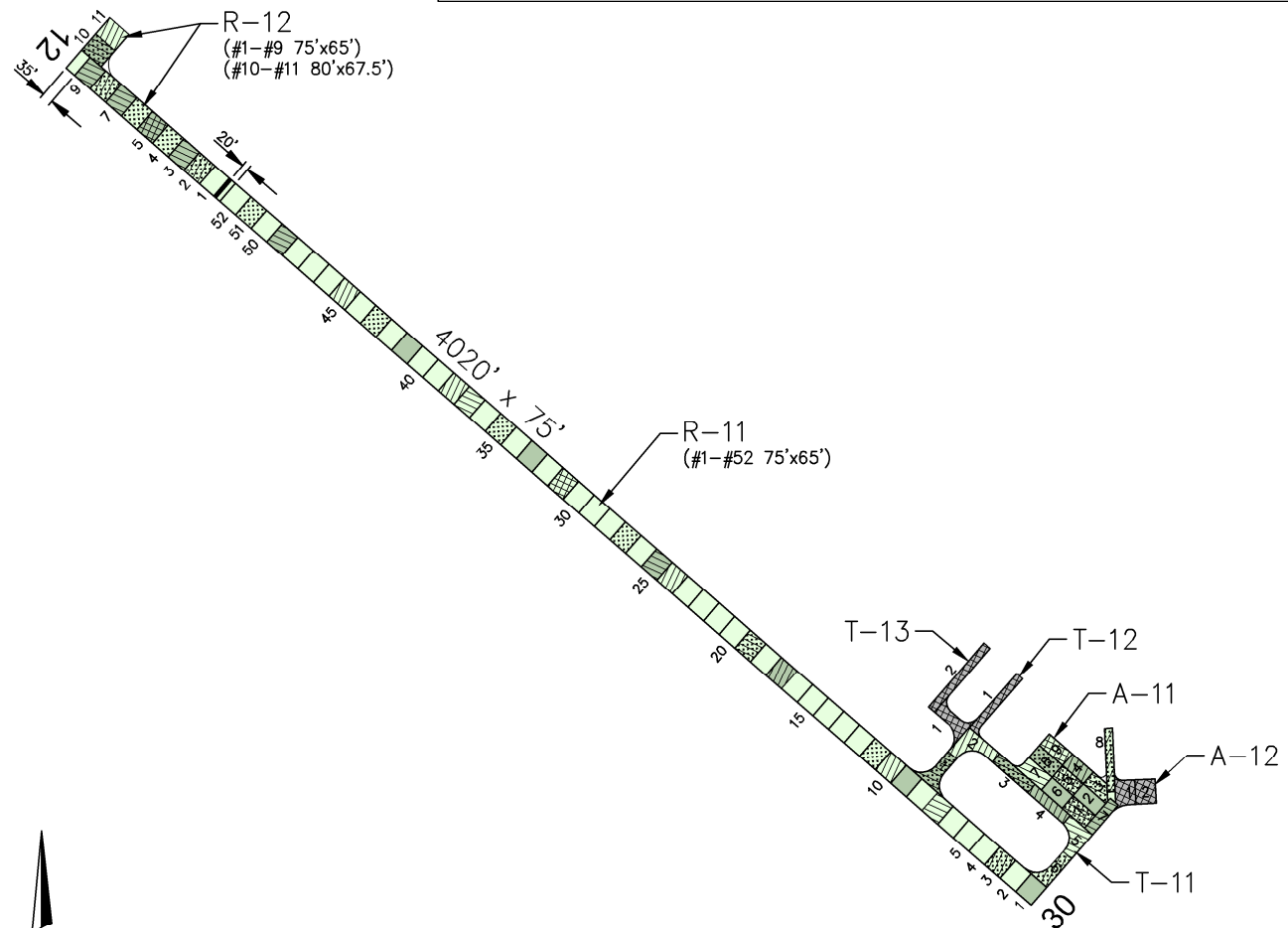
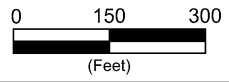
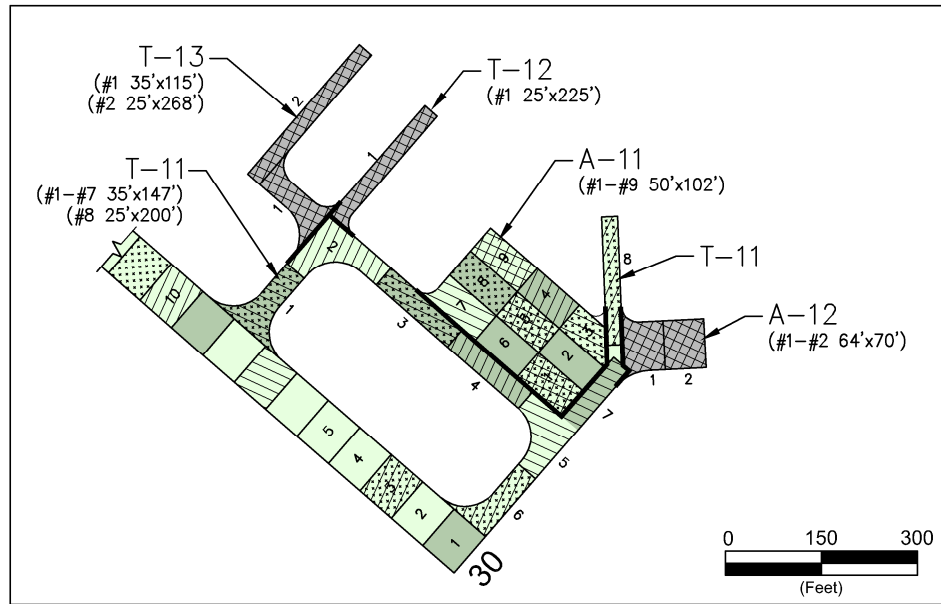

PAVEMENT STRENGTH SURVEY/PAVEMENT CONDITION SURVEY

PAVE. IDENT.	SOIL CLASS	SUB GRADE CLASS	SUBBASE COURSE	BASE COURSE	SURFACE COURSE	OVERLAY	PAVEMENT STRENGTH			REMARKS
							MAX. GROSS LOAD (LBS)			
							SINGLE	DUAL	DUAL TAN.	
RUNWAYS										
R-11		F6	6" P-208	6" P-207	4" P-401	P-608	12,500			1,2,3,4
R-12		F7	14" P-154		4" P-401	P-608	12,500			1,2,3,4
TAXIWAYS										
T-11		F6	6" P-208	6" P-207	4" P-401	P-608	12,500			1,2,3,4
T-12			14" P-154		4" P-401	P-608	12,500			1,2,3,4
T-13			6" P-152	10" P-208	4" P-401	P-608	12,500			2,3,4
APRONS										
A-11		F6	8" P-154	6" P-207	4" P-401	P-608	12,500			1,2,3,4
A-12		F6	GEOGRID, 12" P-152 6" P-154	6" P-207	4" P-401	P-608	12,500			1,2,3,4

REMARKS:

ADAP-01, 1979, CONSTRUCT RUNWAY EXTENSION, CONNECTING TAXIWAY, AND APRON EXTENSIONS; RESURFACE RUNWAY, TAXIWAY, AND APRON.

AIP-01, 1985, REHABILITATE ALL PAVEMENTS.

- AIP-02, 1998, RECONSTRUCT RUNWAY, TAXIWAYS, AND APRON; CONSTRUCT HANGAR ACCESS TAXIWAY (T-12).
- AIP-003-2003, CONSTRUCT HANGAR ACCESS TAXIWAY (T-13); CRACK SEAL, FOG SEAL, AND REMARK ALL PAVEMENTS.
- AIP-006-2010, CRACK SEAL, FOG SEAL, AND REMARK ALL PAVEMENTS.
- AIP-008-2014, CRACK SEAL, SEAL COAT, AND REMARK ALL PAVEMENTS. [MAINTENANCE DONE IN 2015, INSPECTED AFTER PROJECT]

LEGEND [Grid] 2003 SURVEY AREA (NOT SURVEYED) [Solid] 2006 SURVEY AREA [Diagonal] 2009 SURVEY AREA [Cross-hatch] 2012 SURVEY AREA [Dotted] 2015 SURVEY AREA [Green] MAINTAIN: PCI > 60 [Yellow] TRANSITION: PCI 45 TO 60 [Red] RECONSTRUCT: PCI < 45	DATE OF PAVEMENT STRENGTH SURVEY:	JUNE 22, 1967	MONTANA AVIATION SYSTEM PLAN 2015 UPDATE - PAVEMENT CONDITION INDEXES SCOBEY AIRPORT (9S2)	
	EVALUATED BY:	W. MOORE		
	DATE OF MOST RECENT PAVEMENT CONDITION SURVEY:	AUG. 31, 2015	Date: DECEMBER 2015	Prepared For: MONTANA DEPARTMENT OF TRANSPORTATION
	EVALUATED BY:	B. BURKLAND	Prepared By: RPA Robert Peccia & Associates, Inc.	
LOCATION:	SCOBEY MONTANA			

SCOBEY

SCOBEY AIRPORT

8/31/2015



A-11, Surface detail with displaced tie down



A-11, Overview

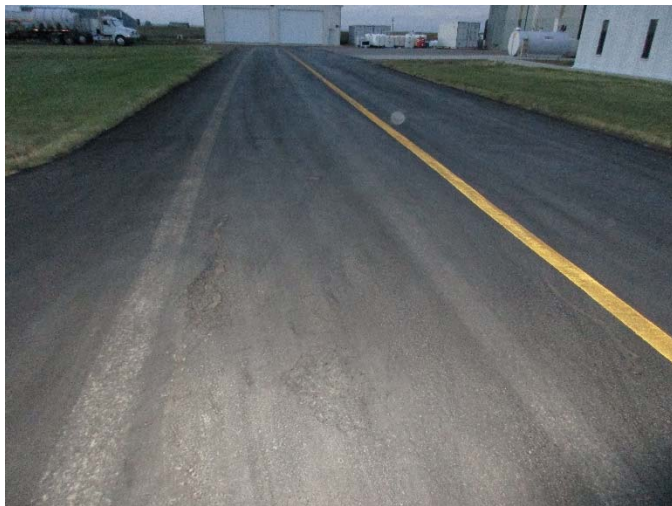

T-11, Overview



T-11, Surface detail with cracking

SCOBEEY AIRPORT

8/31/2015



R-12, Surface detail with partially sealed crack



R-12, Overview



R-11, Overview



R-11, Surface detail with patching

SCOBEY AIRPORT

Branch: 35R

RUNWAY

R-12

Length: 620 LF **Width:** 75 LF **Area:** 46,500 SF **Last Const. :** 1998 **Family:** ACRML15
From: STA 19+80 **To:** STA 26+00 **Surface:** AC

Inspections

Samples Surveyed: 5 **Total Samples:** 12 **Last Inspection Date (RPA)** 8/31/2015 **PCI:** 69

Sample # 2 **Area:** 4875 SF

Distress Description	Severity	Quantity
LONGITUDINAL/TRANSVERSE CRACKING	L	441 LF
LONGITUDINAL/TRANSVERSE CRACKING	M	22 LF
RAVELING	L	49 SF
RAVELING	M	1 SF

Sample # 4 **Area:** 4875 SF

Distress Description	Severity	Quantity
LONGITUDINAL/TRANSVERSE CRACKING	L	349 LF
LONGITUDINAL/TRANSVERSE CRACKING	M	21 LF
RAVELING	L	49 SF

Sample # 6 **Area:** 4875 SF

Distress Description	Severity	Quantity
LONGITUDINAL/TRANSVERSE CRACKING	L	279 LF
PATCHING	L	105 SF
RAVELING	L	49 SF
LONGITUDINAL/TRANSVERSE CRACKING	M	10 LF
PATCHING	M	16 SF

Sample # 8 **Area:** 4875 SF

Distress Description	Severity	Quantity
LONGITUDINAL/TRANSVERSE CRACKING	L	383 LF
PATCHING	L	78 SF
RAVELING	L	49 SF
LONGITUDINAL/TRANSVERSE CRACKING	M	7 LF

Sample # 10 **Area:** 5440 SF

Distress Description	Severity	Quantity
LONGITUDINAL/TRANSVERSE CRACKING	L	639 LF
WEATHERING	L	108 SF
LONGITUDINAL/TRANSVERSE CRACKING	M	8 LF

Extrapolated Distress Quantities*

Distress Description	Severity	Quantity	Density	Deduct
LONGITUDINAL/TRANSVERSE CRACKING	L	3899 LF	8.38 %	20.94
PATCHING	M	30 SF	0.06 %	6.20
LONGITUDINAL/TRANSVERSE CRACKING	M	127 LF	0.27 %	6.15
RAVELING	M	2 SF	0.00 %	4.00
PATCHING	L	341 SF	0.73 %	2.97
RAVELING	L	365 SF	0.79 %	2.27
WEATHERING	L	201 SF	0.43 %	0.28

* Multiple deduct values are scaled down from their algebraic sum to keep the model consistent with experimental data.

Percent of Deduct Values Based on Distress Mechanism

0.0 % Load 100.0 % Climate/Durability 0.0 % Other

SCOBEY AIRPORT

Branch: 35T

TAXIWAY

T-11

Length: 1,214 LF **Width:** 35 LF **Area:** 40,640 SF **Last Const. :** 1998 **Family:** ACRML15
From: R-11 **To:** T-12, A-11, & A-12 **Surface:** AC

Inspections

Samples Surveyed: 4 **Total Samples:** 8 **Last Inspection Date (RPA)** 8/31/2015 **PCI:** 69

Sample # 1 **Area:** 5145 SF

Distress Description	Severity	Quantity
LONGITUDINAL/TRANSVERSE CRACKING	L	270 LF
PATCHING	L	215 SF
RAVELING	L	61 SF
LONGITUDINAL/TRANSVERSE CRACKING	M	10 LF

Sample # 3 **Area:** 5145 SF

Distress Description	Severity	Quantity
LONGITUDINAL/TRANSVERSE CRACKING	L	229 LF
PATCHING	L	61 SF
LONGITUDINAL/TRANSVERSE CRACKING	M	1 LF

Sample # 6 **Area:** 5145 SF

Distress Description	Severity	Quantity
LONGITUDINAL/TRANSVERSE CRACKING	L	238 LF
PATCHING	L	180 SF
DEPRESSION	M	43 SF
DEPRESSION	L	35 SF
LONGITUDINAL/TRANSVERSE CRACKING	M	3 LF
RAVELING	L	2 SF

Sample # 8 **Area:** 5000 SF

Distress Description	Severity	Quantity
LONGITUDINAL/TRANSVERSE CRACKING	L	356 LF
PATCHING	L	163 SF
DEPRESSION	L	104 SF
LONGITUDINAL/TRANSVERSE CRACKING	M	23 LF
RAVELING	L	5 SF
ALLIGATOR CRACKING	L	5 SF

Extrapolated Distress Quantities*

Distress Description	Severity	Quantity	Density	Deduct
LONGITUDINAL/TRANSVERSE CRACKING	L	2174 LF	5.35 %	15.50
PATCHING	L	1231 SF	3.03 %	7.28
ALLIGATOR CRACKING	L	10 SF	0.02 %	7.00
DEPRESSION	M	86 SF	0.21 %	6.35
LONGITUDINAL/TRANSVERSE CRACKING	M	74 LF	0.18 %	4.86
DEPRESSION	L	276 SF	0.68 %	4.63
RAVELING	L	135 SF	0.33 %	1.46

* Multiple deduct values are scaled down from their algebraic sum to keep the model consistent with experimental data.

Percent of Deduct Values Based on Distress Mechanism

15.0 % Load 62.0 % Climate/Durability 23.0 % Other

SCOBEY AIRPORT**FIFTEEN YEAR PROJECTIONS: ESTIMATED AVERAGE ANNUAL COST: \$186,510**

PLAN YEAR: 2016			ESTIMATED COST:			\$132,469	PCI	
SectionID	Maintenance	Local	Global	Major<Crit	Major>Crit	Total	before	after
T-11	Prev. & Seal Coat	\$3,089	\$11,379			\$14,468	67	71
A-11	Prev. & Seal Coat	\$5,054	\$13,020			\$18,074	64	69
R-11	Prev. & Seal Coat	\$11,973	\$71,400			\$83,373	71	74
R-12	Prev. & Seal Coat	\$3,534	\$13,020			\$16,554	67	71
PLAN YEAR: 2017			ESTIMATED COST:			\$19,720	PCI	
SectionID	Maintenance	Local	Global	Major<Crit	Major>Crit	Total	before	after
A-11	Basic Prev.	\$4,066				\$4,066	67	67
T-11	Basic Prev.	\$2,323				\$2,323	69	70
R-12	Basic Prev.	\$2,658				\$2,658	69	70
R-11	Basic Prev.	\$10,673				\$10,673	72	72
PLAN YEAR: 2018			ESTIMATED COST:			\$24,412	PCI	
SectionID	Maintenance	Local	Global	Major<Crit	Major>Crit	Total	before	after
T-11	Basic Prev.	\$3,139				\$3,139	68	68
R-12	Basic Prev.	\$3,591				\$3,591	68	68
A-11	Basic Prev.	\$5,229				\$5,229	64	65
R-11	Basic Prev.	\$12,453				\$12,453	71	71
PLAN YEAR: 2019			ESTIMATED COST:			\$30,696	PCI	
SectionID	Maintenance	Local	Global	Major<Crit	Major>Crit	Total	before	after
A-11	Basic Prev.	\$6,458				\$6,458	62	62
R-12	Basic Prev.	\$4,726				\$4,726	66	66
R-11	Basic Prev.	\$15,382				\$15,382	69	70
T-11	Basic Prev.	\$4,130				\$4,130	66	66
PLAN YEAR: 2020			ESTIMATED COST:			\$40,085	PCI	
SectionID	Maintenance	Local	Global	Major<Crit	Major>Crit	Total	before	after
T-11	Basic Prev.	\$5,347				\$5,347	63	63
A-11	Basic Prev.	\$7,782				\$7,782	60	60
R-12	Basic Prev.	\$6,118				\$6,118	63	63
R-11	Basic Prev.	\$20,838				\$20,838	68	68
PLAN YEAR: 2021			ESTIMATED COST:			\$178,017	PCI	
SectionID	Maintenance	Local	Global	Major<Crit	Major>Crit	Total	before	after
T-11	Prev. & Seal Coat	\$6,832	\$13,192			\$20,023	60	66
R-12	Prev. & Seal Coat	\$7,817	\$15,094			\$22,910	60	66
R-11	Prev. & Seal Coat	\$27,433	\$82,772			\$110,206	66	70
A-11	Prev. & Seal Coat	\$9,784	\$15,094			\$24,878	58	63
PLAN YEAR: 2022			ESTIMATED COST:			\$40,926	PCI	
SectionID	Maintenance	Local	Global	Major<Crit	Major>Crit	Total	before	after
R-12	Basic Prev.	\$6,246				\$6,246	64	64
T-11	Basic Prev.	\$5,459				\$5,459	64	64
R-11	Basic Prev.	\$21,131				\$21,131	68	68
A-11	Basic Prev.	\$8,090				\$8,090	60	61
PLAN YEAR: 2023			ESTIMATED COST:			\$53,031	PCI	
SectionID	Maintenance	Local	Global	Major<Crit	Major>Crit	Total	before	after
R-12	Basic Prev.	\$7,990				\$7,990	61	61
A-11	Basic Prev.	\$10,114				\$10,114	58	58
R-11	Basic Prev.	\$27,944				\$27,944	66	66
T-11	Basic Prev.	\$6,983				\$6,983	61	61
PLAN YEAR: 2024			ESTIMATED COST:			\$471,366	PCI	
SectionID	Maintenance	Local	Global	Major<Crit	Major>Crit	Total	before	after
A-11	Basic Prev.	\$12,476				\$12,476	56	56
R-12	Reconstruct			\$225,517		\$225,517	58	100
R-11	Basic Prev.	\$36,276				\$36,276	64	64
T-11	Reconstruct			\$197,097		\$197,097	58	100
PLAN YEAR: 2025			ESTIMATED COST:			\$61,504	PCI	
SectionID	Maintenance	Local	Global	Major<Crit	Major>Crit	Total	before	after
R-11	Basic Prev.	\$46,415				\$46,415	61	61
A-11	Basic Prev.	\$15,089				\$15,089	53	54

PLAN YEAR: 2026		ESTIMATED COST:				\$1,345,994	PCI	
SectionID	Maintenance	Local	Global	Major<Crit	Major>Crit	Total	before	after
A-11	Prev. & Seal Coat	\$18,016	\$17,498			\$35,514	51	56
R-11	Reconstruct			\$1,310,480		\$1,310,480	58	100
PLAN YEAR: 2027		ESTIMATED COST:				\$15,996	PCI	
SectionID	Maintenance	Local	Global	Major<Crit	Major>Crit	Total	before	after
A-11	Basic Prev.	\$15,670				\$15,670	54	54
R-12	Basic Prev.	\$174				\$174	87	88
T-11	Basic Prev.	\$152				\$152	87	88
PLAN YEAR: 2028		ESTIMATED COST:				\$19,430	PCI	
SectionID	Maintenance	Local	Global	Major<Crit	Major>Crit	Total	before	after
T-11	Basic Prev.	\$319				\$319	84	85
A-11	Basic Prev.	\$18,746				\$18,746	51	51
R-12	Basic Prev.	\$365				\$365	84	85
PLAN YEAR: 2029		ESTIMATED COST:				\$360,566	PCI	
SectionID	Maintenance	Local	Global	Major<Crit	Major>Crit	Total	before	after
R-12	Basic Prev.	\$539				\$539	82	82
A-11	Reconstruct			\$358,540		\$358,540	48	100
T-11	Basic Prev.	\$471				\$471	82	82
R-11	Basic Prev.	\$1,016				\$1,016	87	88
PLAN YEAR: 2030		ESTIMATED COST:				\$3,431	PCI	
SectionID	Maintenance	Local	Global	Major<Crit	Major>Crit	Total	before	after
R-12	Basic Prev.	\$697				\$697	80	80
T-11	Basic Prev.	\$609				\$609	80	80
R-11	Basic Prev.	\$2,125				\$2,125	84	85