

Memorandum

To: E-Distribution

From: Megan Cail, P.E. *MC*
Highways Design Engineer

Date: 7/19/2023

Subject: Project Limits on Plans

Background and Objective

Plan set title sheets are no longer used as the true source of preconstruction linear referencing data. See the Project Linear Referencing Memo dated 11/30/2018 (Revised 3/9/23). Repeated questions have come up about what types of work are included in project limits and which types should be excluded from or noted separately on the title sheet. This memo establishes criteria for project limits and project length shown on the plan set title sheet.

Guidance

Project limits and project length are calculated based on the extent of work performed on the mainline roadway. The following should be shown separately on the title sheet and not included in the project length (if they are outside the limits of mainline roadway work):

- Guardrail
- Temporary Crossover
- Permanent Crossover (is included in linear referencing table project limits in the PFR/SOW and SOW documents)
- Ramp Work

Attached are example title sheets.

If you have any questions, please contact the Highways Engineer.

E-Distribution:
MDT Engineering Bureau Chiefs
MDT District Preconstruction – Project Engineers
MDT Road Design Checkers
Pavement Analysis Engineer
Operations Manager
Maintenance Administrator
Statewide & Urban Planning Section Supervisor

MONTANA DEPARTMENT OF TRANSPORTATION

FEDERAL AID PROJECT IM-HSIP 90-4(70)196

GRADE, GRAVEL, & PLANT MIX SURFACING

SF 139 - RACETRACK BRIDGE REMOVAL

POWELL & DEER LODGE COUNTIES

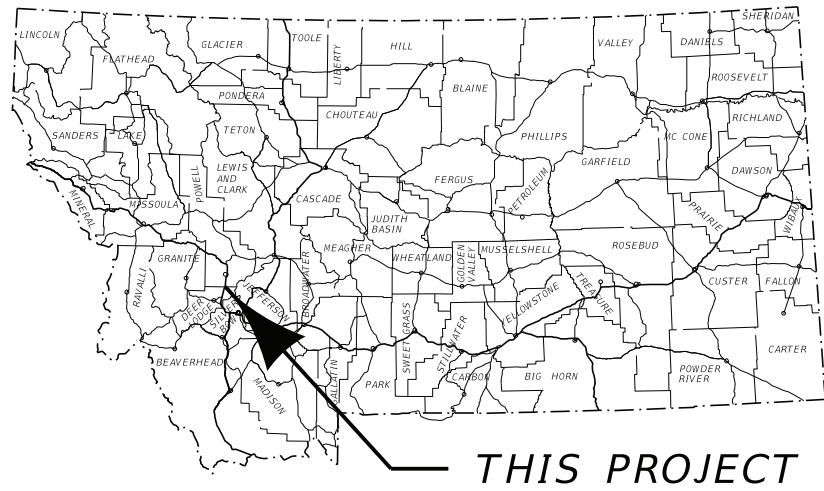

| PROJECT DESIGN DATA | | | |
|---------------------|------|-----------------|----------------|
| PRESENT | 2019 | A.D.T. = | 8500 |
| LETTING | 2021 | A.D.T. = | 8700 |
| DESIGN | 2041 | A.D.T. = | 11050 |
| | | D.H.V. = | 1020 |
| | | TRUCKS = | 24.3 % |
| | | V. = | 70 Mph |
| | | 18 KIP ESAL'S = | 1013 DAILY |
| | | GROWTH RATE = | 1.2 % ANNUALLY |

SURFACING SOURCES -
CONTRACTOR FURNISHED

LENGTH 0.8 MILES

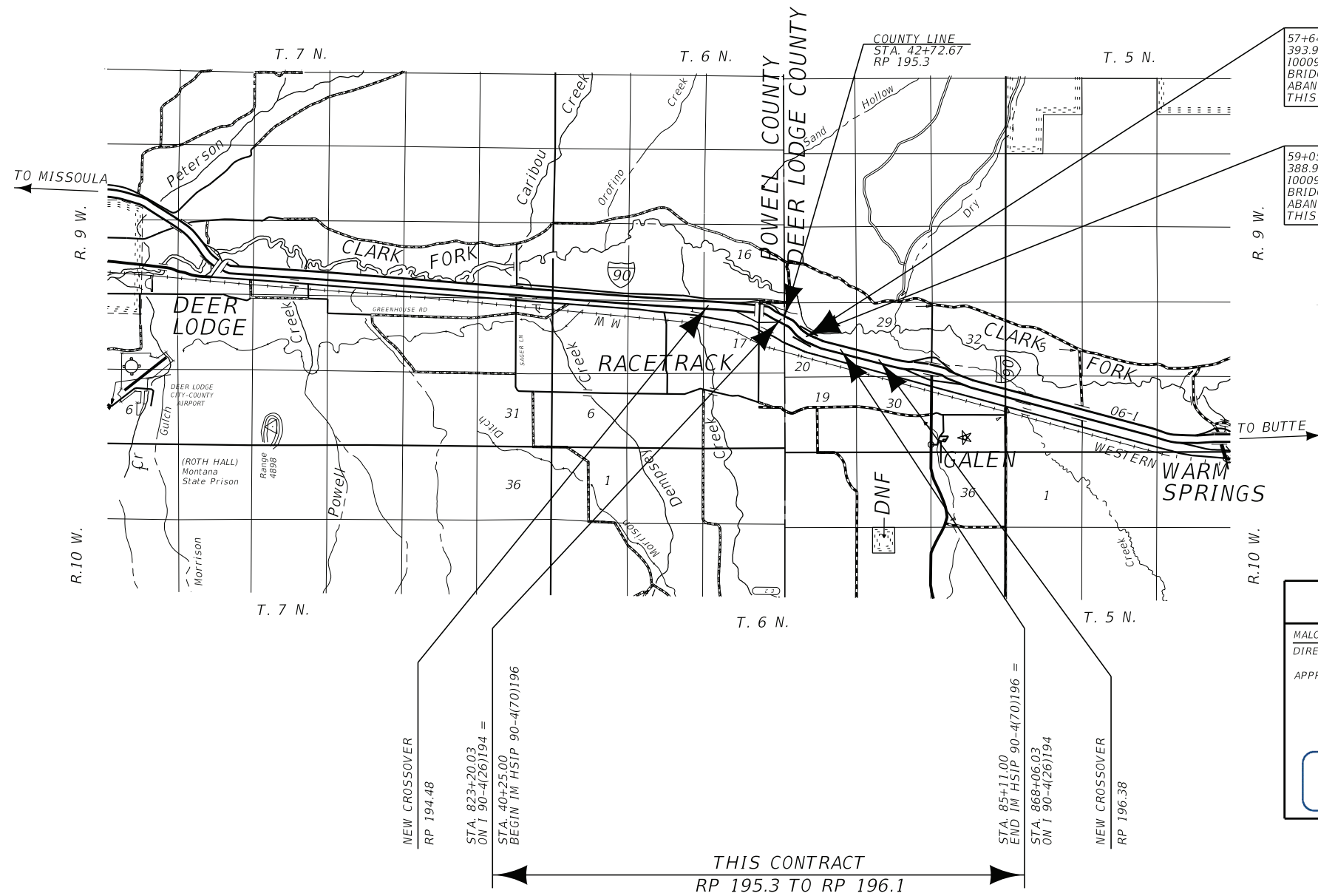

57+64.38 RP 195.67
393.9' X 41.5' EB CONCRETE BRIDGE
100090195+07131
BRIDGE ID 01505
ABANDONED RAILROAD
THIS CONTRACT

59+05.76 RP 195.71
388.9' X 41.5' WB CONCRETE BRIDGE
100090195+07132
BRIDGE ID 01506
ABANDONED RAILROAD
THIS CONTRACT



MONTANA
DEPARTMENT OF TRANSPORTATION

MALCOLM "MACK" LONG
DIRECTOR OF TRANSPORTATION

APPROVED BY:

HIGHWAYS
ENGINEER

DocuSigned by:
Damian Krings
1C71361CE866454...

DAMIAN KRINGS
12113PE
LICENSED PROFESSIONAL ENGINEER

3/15/2023
DATE

| ASSOCIATED PROJECT AGREEMENT NUMBERS | |
|--------------------------------------|---------------------|
| R / W | IM 90-4(88)196 |
| I.C. | |
| P. E. | IM-HSIP 90-4(69)196 |

| | | | | |
|--|-----------------------------|------------------------|------------|-------------|
| | C:\DGN\8613000\rdt\1001.dgn | DESIGNED BY J. BRAZILL | 4/26/2018 | ROAD PLANS |
| | 12/28/2022 | REVIEWED BY K. MUELLER | 10/25/2022 | |
| | 8:31:16 AM CPS - U1150 | CHECKED BY T. JOHNSON | 10/25/2022 | |
| | | | | UPN 8613000 |

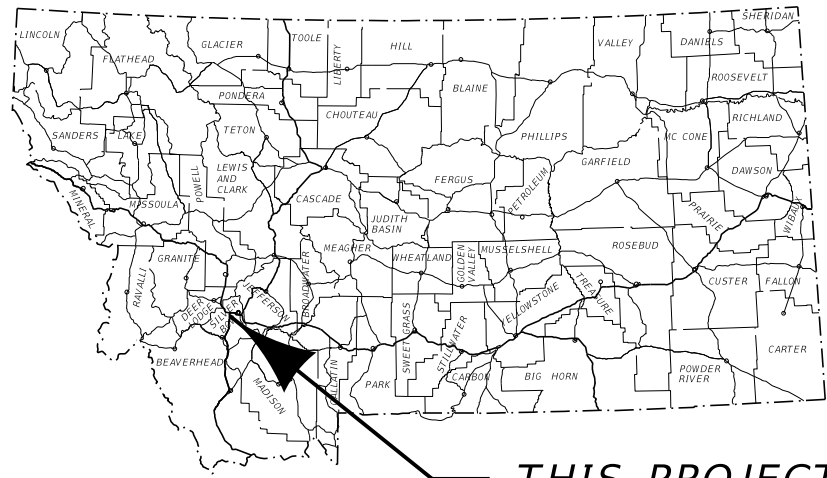

THIS PROJECT

MONTANA DEPARTMENT OF TRANSPORTATION

FEDERAL AID PROJECT IM 15-2(130)116 SEAL & COVER, CULVERT REPLACEMENT BUXTON - NORTH & SOUTH SILVER BOW COUNTY

PROJECT DESIGN DATA

| | | |
|---------|------|------------------------------|
| PRESENT | 2021 | A.D.T. = 5,120 |
| LETTING | 2023 | A.D.T. = 5,300 |
| DESIGN | 2043 | A.D.T. = 7,420 |
| | | D.H.V. = 1020 |
| | | TRUCKS = 19.4 % |
| | | V. = 70 MPH |
| | | 18 KIP ESAL'S = 591 DAILY |
| | | GROWTH RATE = 1.7 % ANNUALLY |

LENGTH 4.9 MILES

SURFACING SOURCES -
CONTRACTOR FURNISHED

- STA. 357+11.65 RP 120.69
100015120+06971
BRIDGE ID 01098
613.5' X 28.0' CONCRETE BRIDGE
LOCAL-CREEK-RARUS RR
THIS CONTRACT
- STA. 356+77.15 RP 120.69
100015120+06972
BRIDGE ID 01099
598.5' X 28.0' CONCRETE BRIDGE
LOCAL-CREEK-RARUS RR
THIS CONTRACT
- STA. 45+18.65 RP 0.099
L47534000+00101
BRIDGE ID 04457
209.5' X 31.4' CONCRETE BRIDGE
INT VICTOR 1 15 003
NOT THIS CONTRACT
- STA. 250+19.00 RP 118.62
100015118+06001
STRUCTURE ID 01097
216.0' X 14.3' X 8.9' STEEL CULVERT
1M S SILVER BOW
THIS CONTRACT
- STA. 122+39.00 RP 116.31
100015116+03161
BRIDGE ID 01095
128.0' X 41.5' CONCRETE BRIDGE
INT BUXTON-BUXTON RD
THIS CONTRACT
- STA. 122+32.00 RP 116.31
100015116+03162
BRIDGE ID 01096
128.0' X 41.5' CONCRETE BRIDGE
INT BUXTON-BUXTON RD
THIS CONTRACT

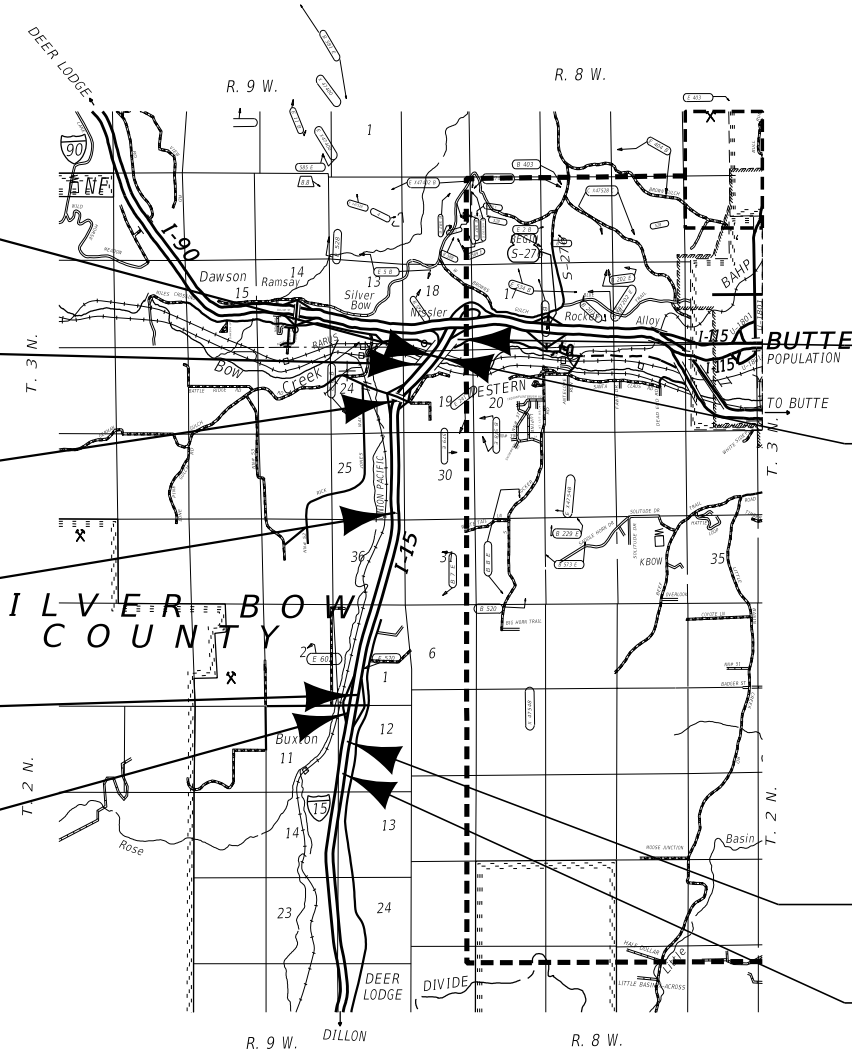

STA 24+80.0 ON
I-ING-15-2(8)118 =

STA 360+18.50 (NORTHBOUND)
STA 359+76.30 (SOUTHBOUND)
END IM 15-2(130)116

STA 100+00.00 (NORTHBOUND)
STA 100+00.00 (SOUTHBOUND)
BEGIN IM 15-2(130)116 =

STA 1052+00.0 ON
IR 15-2(51)116

CROSSOVER AND GUARDRAIL BEYOND PROJECT LIMITS RP 121.00

RP 115.9 to RP 120.8
THIS CONTRACT

CROSSOVER BEYOND
PROJECT LIMITS
RP 115.86

MONTANA
DEPARTMENT OF TRANSPORTATION

MALCOLM "MACK" LONG
DIRECTOR OF TRANSPORTATION

APPROVED BY:

HIGHWAYS
ENGINEER

DAMIAN KRINGS
12113PE
LICENSED PROFESSIONAL ENGINEER

DATE